

Pressalit Magnum (Villeroy & Boch), incl. B33 fixed hinge

No. 104xxx-B33999 with cover

Design/Year

Frogdesign, 1987

Product Description

PRESSALIT toilet seat with cover, model "Magnum", art. no. 104 made of colour ingrained duroplast with stainless steel hinges.

- with B33 fixed hinge of stainless steel
- centre distance: 155 mm
- load - ring seat 240 kg
- 10 year guarantee

Colour Programme xxx

000 white, 030 edelweiss, 050 jasmin, 052 manhattan, 273 pergamon

Hinge Finish

999 Stainless steel

Spare Parts

A4001 Buffer for pushing into seat, oval, grey
 A4003 Buffer for pushing into cover, round, grey
 A7222 Clamp bush, grey
 A9118 Set of straps and screws, stainless steel

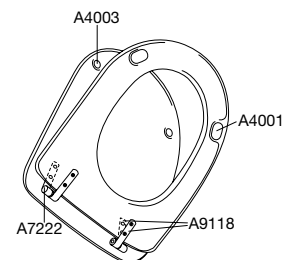
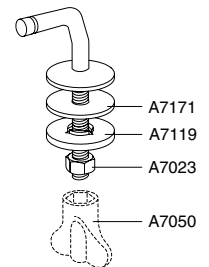
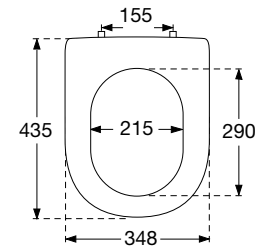

Developed especially for Villeroy & Boch's sanitary programme of the same name.

Product Weight

Net weight approx. 3,100 kg, incl. hinge

Packaging

Single carton
 5 single cartons in a master carton
 12 master cartons (60 seats) per pallet

Dimensions:

482x381x80 mm
 489x388x417 mm

Weight:

3,500 kg
 17,800 kg

Material Description**Toilet seat:**

The material is colour ingrained duroplast (UF A 10 = urea formaldehyde) that contains no environmentally hazardous substances. The body consists of approx. 50% urea (NH₂CONH₂), approx. 25% cellulose and approx. 25% formaldehyde (HCHO), as well as small amounts of various fillers and additives.

Buffers:

EVA (copolymer made of ethylene and vinyl acetate).

Hinge links:

Stainless steel (V2A) model W. no. 1.4301/M in accordance with DIN 17441/85.
 Composition: chrome (cr) 17-19%, nickel (ni) 8-11%, carbon <0.05%, molybdenum, manganese, silicone, sulphur, titanium.

Mount/hinges:

Stainless steel (V2A) model W. no. 1.4301/M in accordance with DIN 17441/85.
 Composition: chrome (cr) 17-19%, nickel (ni) 8-11%, carbon <0.05%, molybdenum, manganese, silicone, sulphur, titanium.

Suitability List

Suitable for Magnum from Villeroy & Boch.

Cleaning Instructions

Use a mild soap solution to clean the seat. Please take care that the seat and hinges are not left damp. Dry off any residual water or cleaning agent with a soft cloth. Avoid contact of the seat and hinges with abrasive, corrosive or chlorine-based cleaners, as these may cause damage or lead to flash rust. Therefore, when cleaning the bowl, make sure that the seat and cover are kept in an upright position until all cleaning agent has been flushed away.

The guarantee includes faults or defects in the material of our products within a period of 10 years.
 Products subject to minor technical modifications and design deviations E. & O.E.



Pressalit A/S, Denmark



www.pressalit.com

European Sales Agencies
 Unit 10c Tanfield Lea (North) Industrial Estate
 Tanfield Lea, Stanley
 Co Durham, DH99UU
 Tel. 01207 236622, Fax 01207 236633
info@europeansalesagencies.com
www.europeansalesagencies.com

Pressalit A/S
 Pressalitvej 1
 DK-8680 Ry
 Tel. (+45) 8788 8788
 Fax (+45) 8788 8789
pressalit@pressalit.com

PRESSALIT®
 seats