

Pressalit 300® Sphinx, incl. BT8 fixed hinge

No. 548xxx-BT8999 with cover
No. 103xxx-BT8999 without cover

Design/Year

Frogdesign, 1987, registered trade mark

Product Description

PRESSALIT toilet seat with cover, model "Pressalit 300", art. no. 548 made of colour ingrained duroplast with stainless steel hinges.

- with BT8 fixed hinge of stainless steel
- centre distance: 155 mm
- load - ring seat 240 kg
- 10 year guarantee

Colour Programme xxx

With cover: 000 white, 273 pergamon
Without cover: 000 white, 273 pergamon

Alternative Hinge

D08 Fixed hinge (for wall mounted)

Hinge Finish

999 Stainless steel

Spare Parts

A4001 Buffer for pushing into seat, oval, grey
A4003 Buffer for pushing into cover, round, grey
A7220 Distance bush for seat without cover
A7222 Clamp bush, grey
A9118 Set of straps and screws, stainless steel

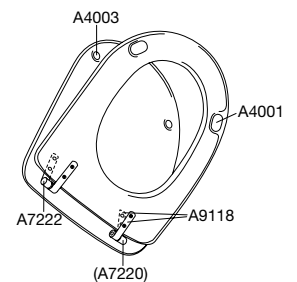
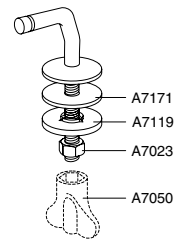
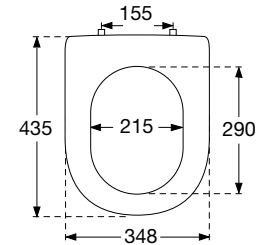

Developed especially for Sphinx 300 sanitary programme of the same name.

Product Weight	Net weight approx. 3,100 kg, incl. hinge		
Packaging	Single carton 5 single cartons in a master carton 12 master cartons (60 seats) per pallet	Dimensions: 482x381x80 mm 489x388x417 mm	Weight: 3,500 kg 17,800 kg
Material Description	<p>Toilet seat: The material is colour ingrained duroplast (UF A 10 = urea formaldehyde) that contains no environmentally hazardous substances. The body consists of approx. 50% urea (NH₂CONH₂), approx. 25% cellulose and approx. 25% formaldehyde (HCHO), as well as small amounts of various fillers and additives.</p> <p>Buffers: EVA (copolymer made of ethylene and vinyl acetate).</p> <p>Hinge links: Stainless steel (V2A) model W. no. 1.4301/M in accordance with DIN 17441/85. Composition: chrome (cr) 17-19%, nickel (ni) 8-11%, carbon <0.05%, molybdenum, manganese, silicone, sulphur, titanium.</p> <p>Mount/hinges: Stainless steel (V2A) model W. no. 1.4301/M in accordance with DIN 17441/85. Composition: chrome (cr) 17-19%, nickel (ni) 8-11%, carbon <0.05%, molybdenum, manganese, silicone, sulphur, titanium.</p>		
Suitability List	Suitable for Sphinx 300.		
Cleaning Instructions	<p>Use a mild soap solution to clean the seat. Please take care that the seat and hinges are not left damp. Dry off any residual water or cleaning agent with a soft cloth. Avoid contact of the seat and hinges with abrasive, corrosive or chlorine-based cleaners, as these may cause damage or lead to flash rust. Therefore, when cleaning the bowl, make sure that the seat and cover are kept in an upright position until all cleaning agent has been flushed away.</p> <p>The guarantee includes faults or defects in the material of our products within a period of 10 years. Products subject to minor technical modifications and design deviations E. & O.E.</p>		

